

PRESS RELEASE (Updated with images, 2 pp)  
July 3, 2016

Seattle Times: [rgrunbaum@seattletimes.com](mailto:rgrunbaum@seattletimes.com)  
Peninsula Daily News: [news@peninsuladailynews.com](mailto:news@peninsuladailynews.com)  
Sequim Gazette: [editor@sequimgazette.com](mailto:editor@sequimgazette.com)  
Port Townsend Leader: [news@ptleader.com](mailto:news@ptleader.com)  
Forks Forum: [editor@forksforum.com](mailto:editor@forksforum.com)

### ***Innovation in Action - Sequim Inventors Awarded Patents***

Sequim Inventor Donald Rapelje was awarded US Patent 9,345,237 on May 24, 2016 for his invention of a Soft Bait Fishing Lure. The patented Rapelje lure mimics the lifelike swimming action of living bait fish. A key feature of the Rapelje '237 patent is the provision of a quick-disconnect assembly which permits quick replacement of the flexible tail segment in case of damage to the lure by a fish-strike during fishing, or changing to a different tail segment to attract a different fish species. Mr. Rapelje has been working on securing patent protection for his unique design for over 10 years, and is now seeking partners for commercialization. The flexible tail is item 1 in the drawing, the quick-disconnect is item 3, and the hard forebody is item 4:

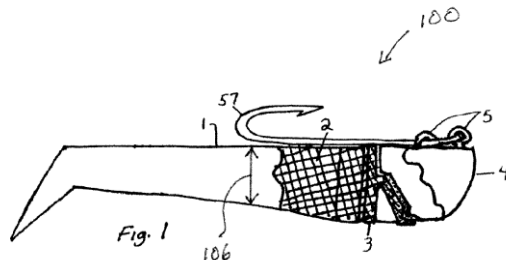

Mr. Rapelje was assisted in obtaining a patent on his innovative lure by Innovation Law Group of Sequim, WA. ILG is the premier patent and trademark firm on the Olympic Peninsula, offering over 50years experience in all phases of Intellectual Property and related business counseling from its Sequim office. ILG can be reached at 360-681-7305 or [www.InnovationLaw.com](http://www.InnovationLaw.com).

Sequim Inventor Roger Maes, of Amaezing Tools was awarded US Patent 9,358,679 on June 7, 2016 for his innovative Mobile Work Station (“MWS”). The patented Maes MWS includes a lockable box on wheels that can be leveled in the field to form a work platform. The Maes patented ‘697 MWS includes side rails that are adjustable to be oriented at 90°, both horizontally and vertically to each other, to insure precise alignment for accurate welding of pipe and rod sections in the field. The precise alignment feature permits accurate welding of successive pipe sections oriented at a different angle than the preceding section resulting in compound 3-D forms in the field. The patented Maes MWS includes special clamps for holding hand and power tools. The clamps are specially designed to engage the box’s side rails. The accessory tools include: vices, grinders, chop saws, bending jigs and a powered rotator having an adjustable counter-balance to permit welding of pipes as they are being rotated.

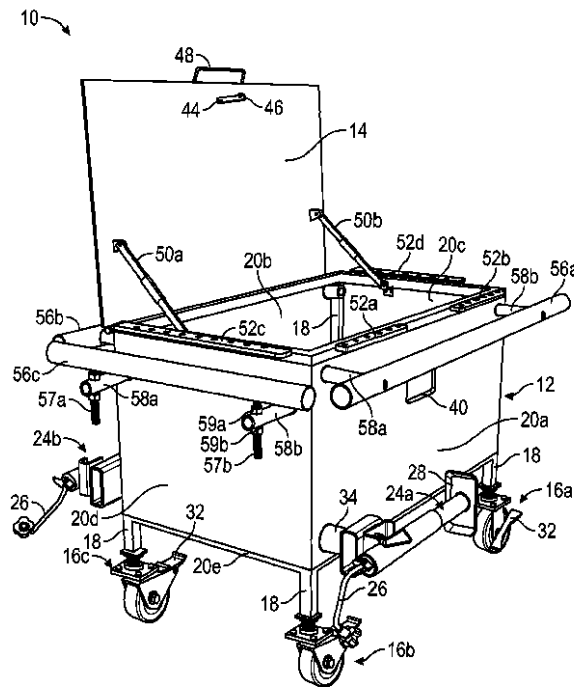

Mr. Maes was assisted in the drafting and obtaining his patent by Innvoation Law Group of Sequim, WA. ILG is the premier patent and trademark firm on the Olympic Peninsula, offering over 50years experience in all phases of Intellectual Property and related business counseling from its Sequim office. ILG can be reached at 360-681-7305 or [www.InnovationLaw.com](http://www.InnovationLaw.com).